

FRION® Shower Head Filter

How to Set Up the Filter

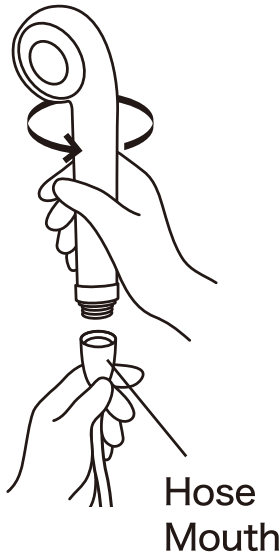

1 Detach the shower head from the hose.



2 Attach the shower filter housing to the shower head. Tighten by hand.

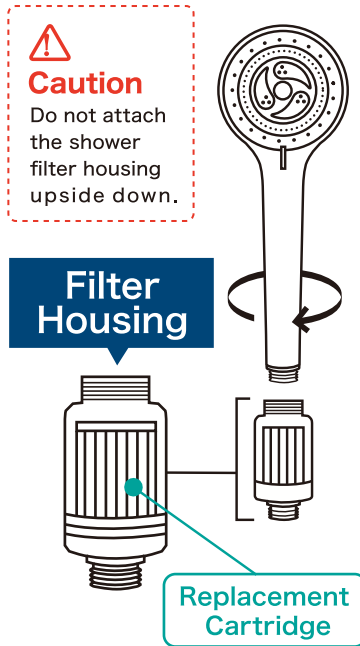

3 Attach the hose to the bottom of the shower filter housing.

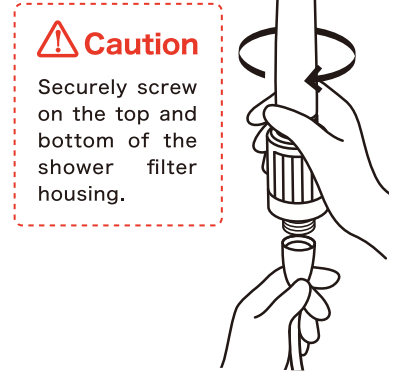

4 Turn on the water and check for leaks.

FRION® Replacement Cartridge

How to Replace the Cartridge



1 Place the washer inside the shower filter housing.

2 Insert the replacement cartridge so that the end with the hole faces the washer.

3 Place the rubber ring on the cartridge so that the protrusion touches the cartridge.

4 Tighten the cap.

5 Make sure the rubber ring is properly set inside the cap.

6 Attach the shower and the hose.

7 Turn on the water and check for leaks.

Attach to the Hose



Replacement Cartridge



Attach to the Shower

- We recommend that you change the cartridge if you do not use the shower for a while (about 1 month).
- Please replace the cartridge if it smells bad or gets extremely dirty.
- The life of the cartridge may vary depending on water quality, the amount of water used, and the environment.

Caution
Check the top and bottom of the shower filter housing when you replace the cartridge.